

CURRENT SENSE INDUCTORS

- Designed for switching power supply applications.
- Molded construction-hole thru center for primary lead.
- 2500 rms HI-POT.
- Frequency range from 10KHz to 200KHz.
- 0.50 millimeter minimum material thickness from hold I.D. to coil.

ELECTRICAL SPECIFICATIONS @25°C

Model Number Inductor Without Primary	Schematic Figure	Secondary Turns	Secondary Inductance (mH)Min.	Secondary Inductance Test Voltage 15.75 KHz	Secondary DCR (ohms)Max	Secondary Rated Terminating Resistance (ohms)Nom.	Primary Unipolar (Amp-μ s) Rating Max.	Primary Bipolar (Amp-μ s) Rating Max.	1 Turn Primary Peak Sense Current (Amps)
UT33686	2A	50	5.0	0.5	0.7	50	150	300	20
UT33687	2A	100	20.0	1.0	1.40	100	300	600	20
UT33688	2A	200	80.0	2.0	4.50	200	600	1200	20
UT33689	2A	300	180.0	3.0	11.0	300	900	1600	20
UT33717	2B	50CT	5.0	0.5	0.7	50	150	300	20
UT33718	2B	100CT	20.0	1.0	1.40	100	300	600	20
UT33719	2B	200CT	80.0	2.0	4.50	200	600	1200	20
UT33720	2B	300CT	180.0	3.0	11.0	300	900	1800	20

* For RoHS compliant products, a.)The Ordering Code: TG-Model No. ex. TG-UT33688
b.) Solder : Sn/ Cu; c.)Date Code suffix to "G" (xxxxG)



INDUCTOR

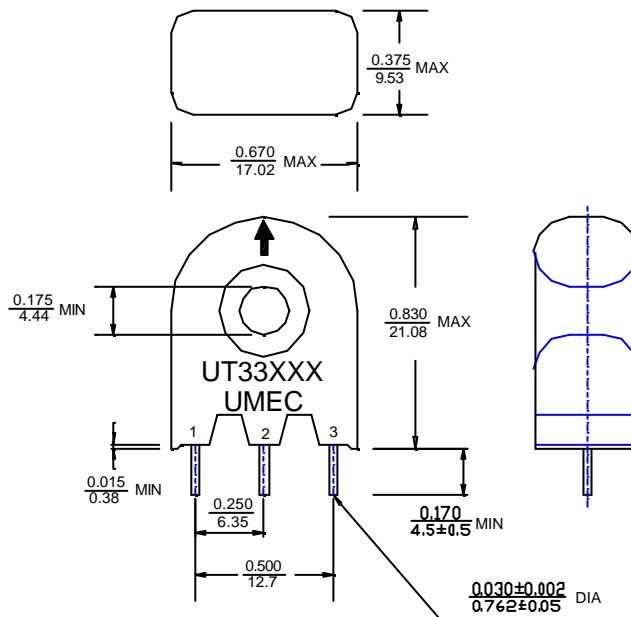
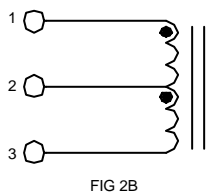
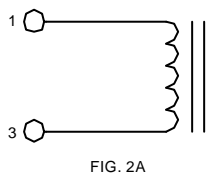

XXX=±010 inches
XX=1,25 mm

*Specifications are subject to change without prior notice.

DATA SHEET 02-33 FEB./06
1 OF 1



UNIVERSAL MICROELECTRONICS CO.,LTD.
TEL:886-4-23590096 FAX:886-4-23590129

3,27TH RD.,TAICHUNG INDUSTRIAL PARK,
TAICHUNG,TAIWAN,R.O.C