

SMD POWER INDUCTORS

PL763, PL965, PL1375 Series

- This is a high current and low inductance SMD power inductance to be constructed by one turn flat wire and cut a small gap on core.
- Operating temperature range: -40°C to +125°C.

ELECTRICAL SPECIFICATIONS @25°C

MODEL NUMBER	MARK	L±20% ¹ (nH)	DCR(mΩ) Max.	L±20% @ I _{rated} (nH)	I _{rated} ¹ (A _{dc})	I _{sat} ² (A)		
						-40°C	25°C	125°C
PL763-R10	R10	100	0.39	95	15	18.2	18	16.2
PL965-R15	R15	150	0.56	142.5	15	18.2	18	16.2
PL965-R20	R20	200	0.56	190	15	17	16.8	15.12

1. The rated current as listed is either the saturation current or the heating current depending on which value is lower.
2. The saturation current is the current which causes the inductance to drop by 10% at the stated ambient temperatures (-40°C, 25°C, 125°C). This current is environment and applying a short duration pulse current (to eliminate self-heating effects) to the component.
3. For RoHS compliant products: a.)The Ordering Code: TG-Model No. ex. TG-PL763-R10
b.)Solder : Sn/Ag/Cu c.)Date Code suffix to "G" (xxxxG)



DIMENSION & DRAWING

PL763

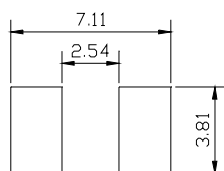
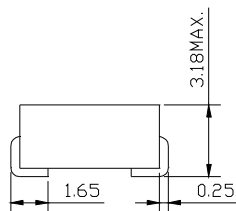
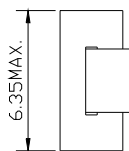
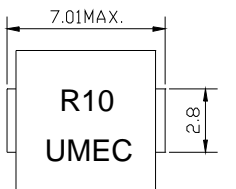

SUGGESTED PAD LAYOUT

PL965

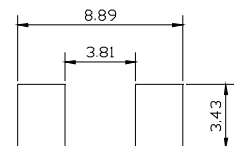
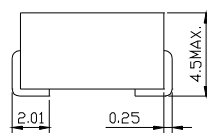
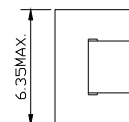
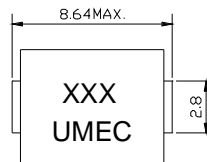

SUGGESTED PAD LAYOUT

DATA SHEET 12-30 MAR./06
1 OF 2



UNIVERSAL MICROELECTRONICS CO.,LTD.
TEL:886-4-23590096 FAX:886-4-23590129

3,27TH RD.,TAICHUNG INDUSTRIAL PARK,
TAICHUNG,TAIWAN,R.O.C

SMD POWER INDUCTORS

PL763, PL965, PL1375 Series

- This is a high current and low inductance SMD power inductance to be constructed by through one turn flat wire and cut a small gap on core.
- Operating temperature range: -40°C to +125°C.

ELECTRICAL SPECIFICATIONS @25°C

MODEL NUMBER	HOOKUP	MARK	L±20% (nH)	DCR(mΩ) Max.	L±20% @ Irated (nH)	Irated ¹ (A)	Isat ² (A)		
							-40°C	25°C	125°C
PL1375-R33	Series	R33	330	0.9	297	20	40	40	32
PL1375-R33	Parallel	R33	82.5	0.225	74	40	40	40	40
PL1375-R47	Series	R47	470	0.9	423	20	37	35	26
PL1375-R47	Parallel	R47	117.5	0.225	105	40	40	40	40
PL1375-R68	Series	R68	680	0.9	612	19	26	25	19
PL1375-R68	Parallel	R68	170	0.225	153	34	40	40	34
PL1375-1R0	Series	1R0	1000	0.9	900	14	19	18	14
PL1375-1R0	Parallel	1R0	250	0.225	225	24	36	35	24

1. The rated current as listed is either the saturation current or the heating current depending on which value is lower.
2. The saturation current is the current which causes the inductance to drop by 10% at the stated ambient temperatures (-40°C, 25°C, 125°C). This current is environment and applying a short duration pulse current (to eliminate self-heating effects) to the component.
3. For RoHS compliant products: a.)The Ordering Code: TG-Model No. ex. TG-PL1375-R33
b.)Solder : Sn/Ag/Cu c.)Date Code suffix to "G" (xxxxG)



DIMENSION & DRAWING

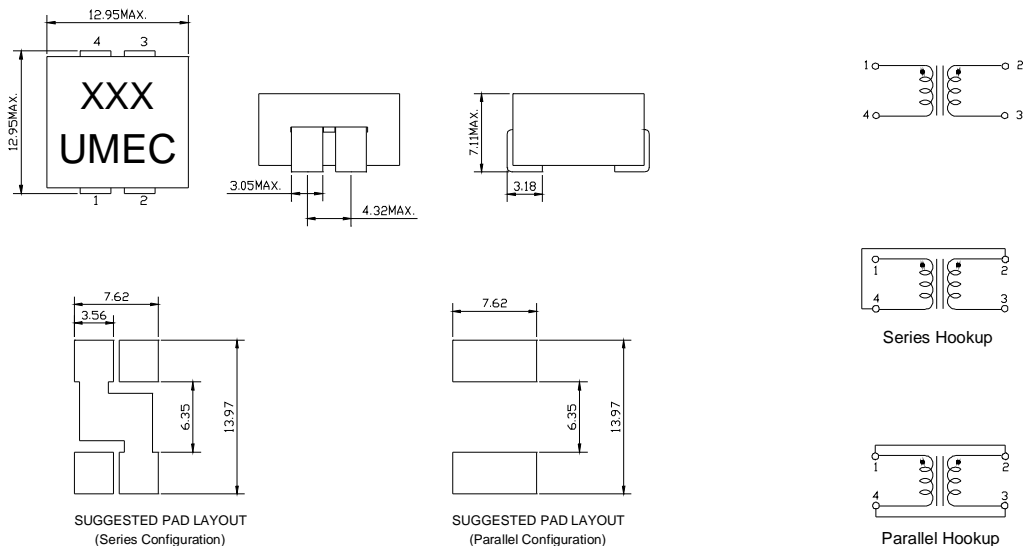

*Specifications are subject to change without prior notice.

DATA SHEET 12-30 MAR./06
2 OF 2



UNIVERSAL MICROELECTRONICS CO.,LTD.
TEL:886-4-23590096 FAX:886-4-23590129

3,27TH RD.,TAICHUNG INDUSTRIAL PARK,
TAICHUNG,TAIWAN,R.O.C