

ISDN

UM MODEL NO.:	SPECIFICATION	REV.	
UT21542	4-Fold Common Mode Choke	A1	98/47

Characteristic data:

RI ~ IV $\approx 1.8\Omega$
 In=150mA
 Tu(amb) $\leq 60^{\circ}\text{C}$

Schematic diagram:

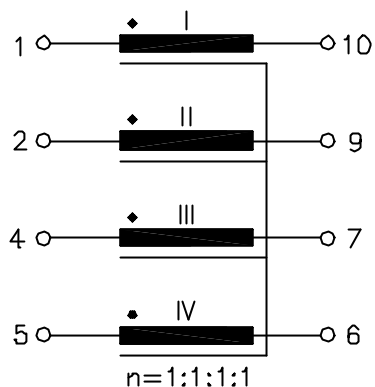

Electrical Specification at 25⁰C:

- 1.) L=90mH +50%/-30%, at 10KHz 100mV
- 2.) Polarity and turns ratio tolerance $\pm 1\%$
- 3.) Ls I $\leq 2.0\mu\text{H}$, (NII, III, IV shorted), at 100KHz 100mV
- 4.) HI-pot test:
 Up=0.5KVrms, 2s(Winding to Winding)

Dimension:

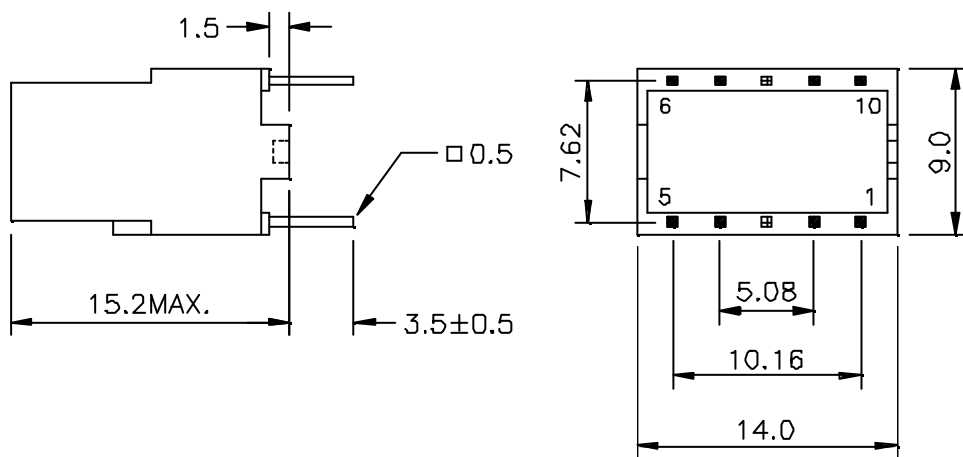

NOTE: Specifications are subject to change without prior notice.

UNIT: mm

Tolerances $\pm 0.2\text{mm}$

E10-013-C



UNIVERSAL MICROELECTRONICS CO.,LTD.
 TEL:886-4-23590096 FAX:886-4-23590129
<http://www.umec-web.com> Email:business@umec.com.tw

3,27TH RD.,TAICHUNG INDUSTRIAL PARK,
 TAICHUNG,TAIWAN,R.O.C