

ISDN

UM MODEL NO.:	SPECIFICATION	REV.	
UT28534	4-Fold Common Mode Choke	A2	00/27

Characteristic data:

$R_I \sim IV \approx 0.48\Omega \pm 15\%$
 $I_n = 300\text{mA}$
 $T_u(\text{amb}) \leq 60^\circ\text{C}$

Schematic diagram:

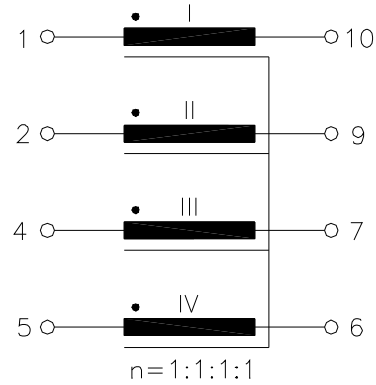

Electrical Specification at 25⁰C:

- 1.) $L = 5\text{mH} +50\%/-30\%$, at 10KHz 100mV
- 2.) Polarity and turns ratio tolerance: $\pm 1\%$
- 3.) $L_s \leq 0.5\mu\text{H}$, (NII,III,IV shorted), at 100KHz 100mV
- 4.) HI-pot test:
 $U_p = 0.5\text{KV}_{\text{rms}}, 2\text{s}$ (Winding to Winding)

Dimension:

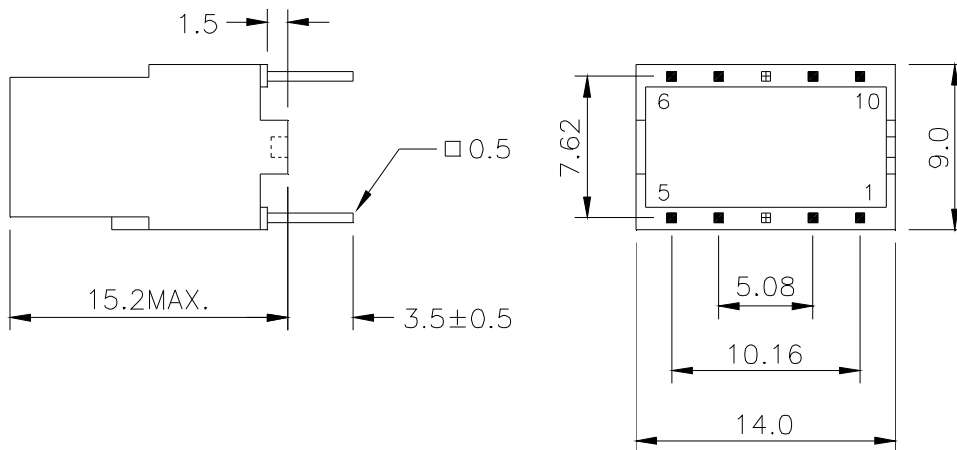

NOTE: Specifications are subject to change without prior notice.

UNIT: mm

Tolerances: $\pm 0.2\text{mm}$



UNIVERSAL MICROELECTRONICS CO.,LTD.
 TEL:886-4-23590096 FAX:886-4-23590129
<http://www.umec-web.com> E-mail:business@umec.com.tw

3,27TH RD.,TAICHUNG INDUSTRIAL PARK,
 TAICHUNG,TAIWAN,R.O.C

E10-013-C