

ISDN

UM MODEL NO.:	SPECIFICATION	REV.	
UT28550	4-Fold Common Mode Choke	A1	99/05

Characteristic data:

RI ~ IV ≤ 1.5Ω

In = 250mA

Tu(amb) ≤ 60°C

Schematic diagram:

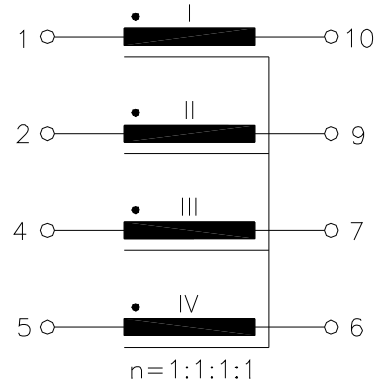

Electrical Specification at 25°C:

- 1.) L = 11.5mH +50%/-30%, at 10KHz 100mV
- 2.) Polarity and turns ratio tolerance: ±1%
- 3.) Ls I ≤ 1.5uH, (NII,III,IV shorted), at 100KHz 100mV
- 4.) HI-pot test:
Up = 1.0KVrms, 2s (Winding to Winding)

Dimension:

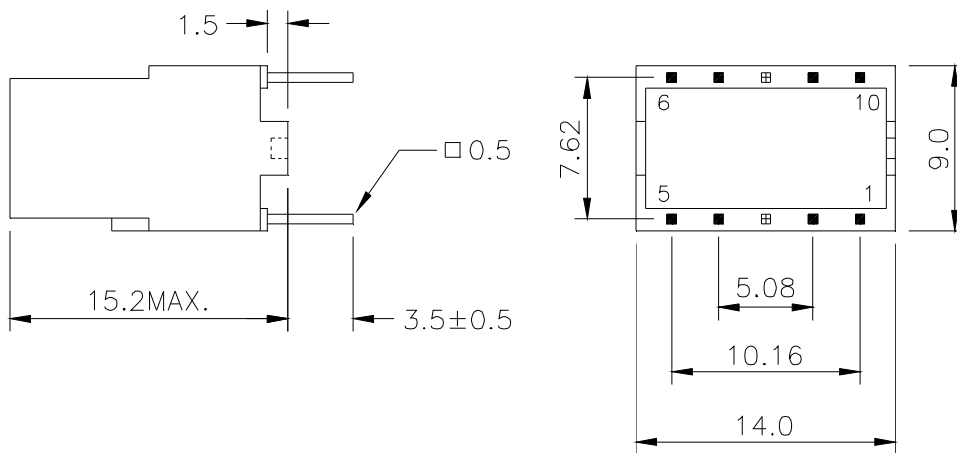

NOTE: Specifications are subject to change without prior notice.

UNIT: mm

Tolerances: ±0.2mm



UNIVERSAL MICROELECTRONICS CO.,LTD.
TEL:886-4-23590096 FAX:886-4-23590129
<http://www.umec-web.com> E-mail:business@umec.com.tw

3,27TH RD.,TAICHUNG INDUSTRIAL PARK,
TAICHUNG,TAIWAN,R.O.C

E10-013-C