

# DATA SHEET

UM MODEL NO.:	SPECIFICATIONS	REV.	1/1
UT34158	COMMON CHOKE	A0	98/48

## ELECTRICAL SPECIFICATIONS AT 25<sup>0</sup>C

1. TURNS RATIO : 8 : 8 15.75KHz 1V PIN( 1-4 ) : ( 8-5 )
2. INDUCTANCE : 50 $\mu$ H MIN. 100KHz 1V PIN( 1-4 )
3. DC RESISTANCE : 0.15 $\Omega$  MAX. PIN( 1-4 )
4. DC RESISTANCE : 0.15 $\Omega$  MAX. PIN( 8-5 )
5. DIELECTRIC STRENGTH : 250 Vdc/LEAKAGE CURRENT = 1mA/ 2SEC  
PIN ( 1-4 ) : ( 8-5 )

## DIENENSIONS & SCHEMATICS :

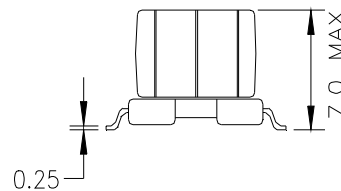
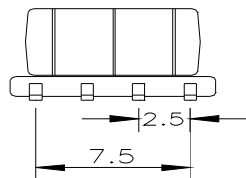
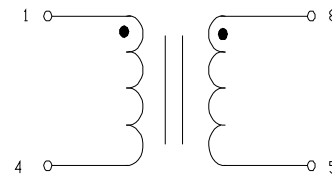
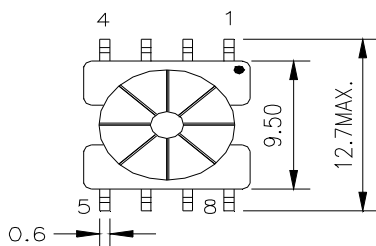

Note: Specifications are subject to change without prior notice.

UNIT : mm

Tolerance:  $\pm 0.25$ mm

