

ADSL/ISDN

UM MODEL NO.:	SPECIFICATIONS	REV.	
UTAPF226	ADSL/ISDN CO SPLITTER	Preliminary	2004/51

Electrical specification at 25°C:

- 1.) Impedance : 135Ω:135Ω or 150 Ω:150Ω.
- 2.) D.C.R : 12.5 Ωmax. , PIN(2-3),PIN(1-4) connected.
- 3.) Insertion Loss : 0.8dB max. , at 1k Hz to 40k Hz , LINE to ISDN PORT , when $Z_T=Z_L=135\Omega$.
: 2.0dB max. , at 40k Hz to 80k Hz , LINE to ISDN PORT , when $Z_T=Z_L=135\Omega$.
: 1.2dB max. , at 1k Hz to 60k Hz , LINE to ISDN PORT , when $Z_T=Z_L=150\Omega$.
- 4.) Return Loss : 2.0dB max. , at 60k Hz to 80k Hz , LINE to ISDN PORT , when $Z_T=Z_L=150\Omega$.
: 16dB min. , 1k Hz to 40k Hz , LINE to ISDN PORT , ISDN PORT with 135Ω .
: 14dB min. , 40k Hz to 80k Hz , LINE to ISDN PORT , ISDN PORT with 135Ω .
: 16dB min. , 1k Hz to 60k Hz , LINE to ISDN PORT , ISDN PORT with 150Ω .
: 14dB min. , 60k Hz to 80k Hz , LINE to ISDN PORT , ISDN PORT with 150Ω .
- 5.) Attenuation : 65dB min. , 150kHz to 1100kHz , LINE to ISDN PORT , when $Z_T=Z_L=135\Omega$.
: 65dB min. , 150kHz to 1100kHz , LINE to ISDN PORT , when $Z_T=Z_L=150\Omega$.
- 6.) Longitudinal Balance : 40dB min. , 300Hz to 30kHz , LINE to ISDN PORT.
: 46dB min. , 30kHz to 1100kHz , LINE to ISDN PORT.
: 40dB min. , 1100kHz to 5MHz , LINE to ISDN PORT.
- 7.) Delay Distortion : 20 μSec max. , 200 Hz to 80k Hz .
- 8.) Isolation Resistance : 5MΩmin with 120V_{DC} , PIN(1-2) to PIN(3-4) .
- 9.) Operating Temperature : -40~+85°C.
- 10.) Storage Temperature : 0~+70°C.

Note: Designed to meet ETSI specification TS 101 952-1-3.

Schematic diagram & Dimensions:

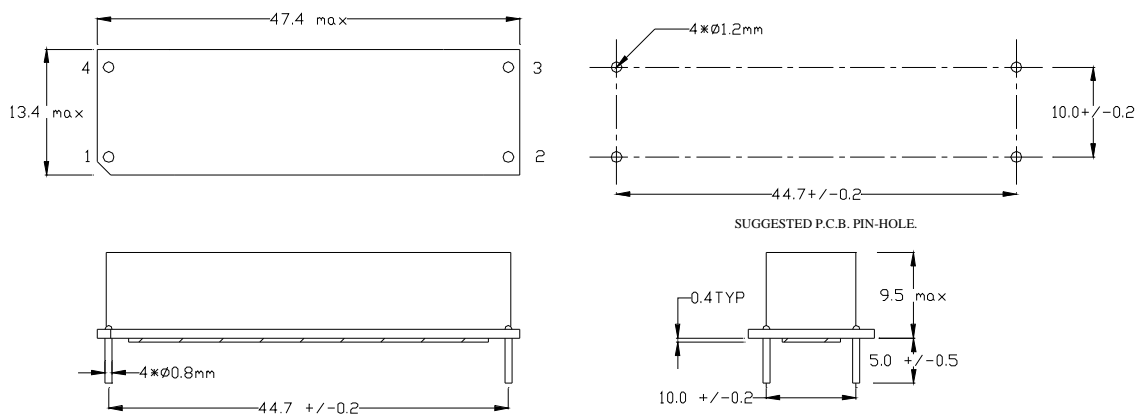

Test Block Diagram

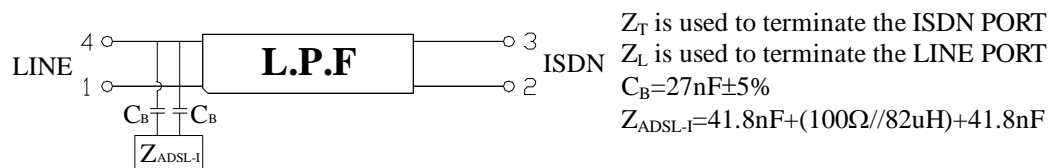

UNIT : mm

E10-032-C



UNIVERSAL MICROELECTRONICS CO.,LTD.
 TEL:886-4-23590096 FAX:886-4-23590129
<http://www.umec-web.com> E-mail:business@umec.com.tw

3,27TH RD.,TAICHUNG INDUSTRIAL PARK,
 TAICHUNG,TAIWAN,R.O.C